

### begane grond

- BC1
- BC2
- BC3
- BC4
- BC5
- BC6
- BC7
- BC8
- BC9

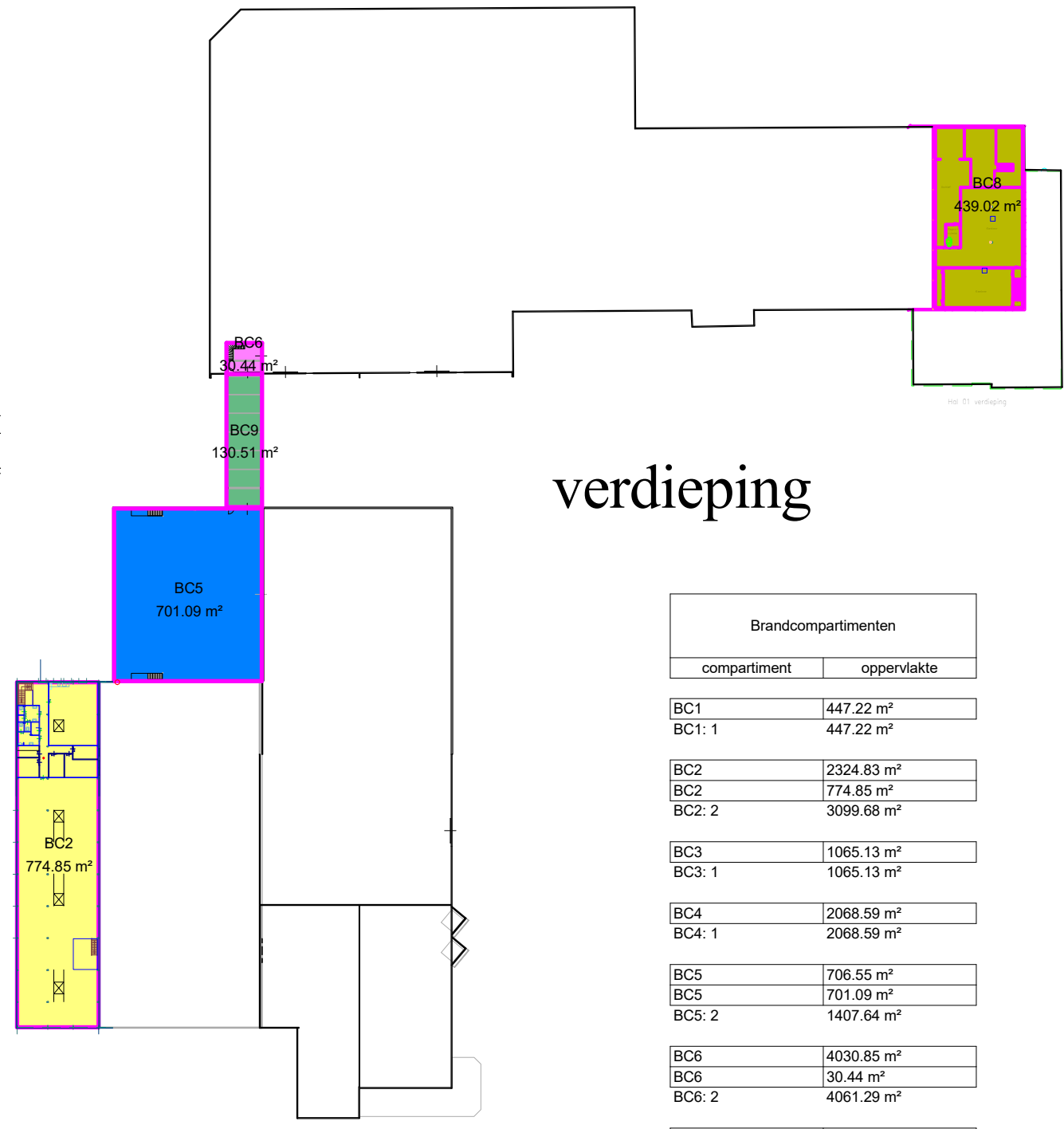
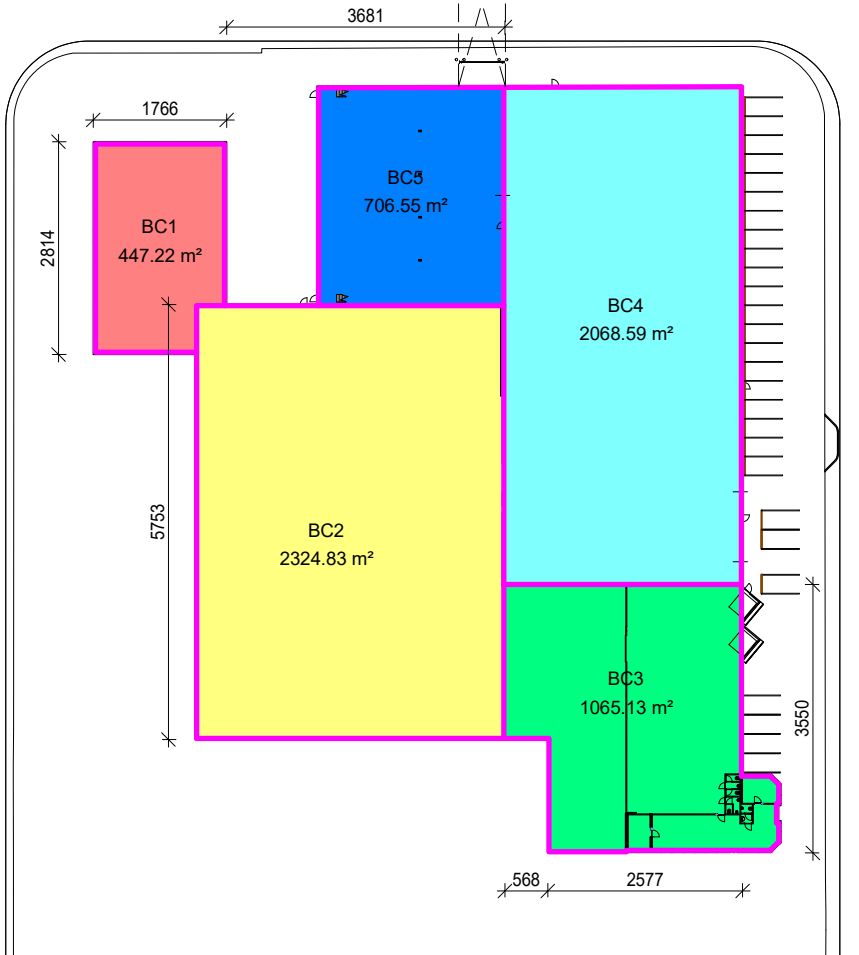

### verdieping

Brandcompartimenten	
compartiment	oppervlakte
BC1	447.22 m <sup>2</sup>
BC1: 1	447.22 m <sup>2</sup>
BC2	2324.83 m <sup>2</sup>
BC2: 1	774.85 m <sup>2</sup>
BC2: 2	3099.68 m <sup>2</sup>
BC3	1065.13 m <sup>2</sup>
BC3: 1	1065.13 m <sup>2</sup>
BC4	2068.59 m <sup>2</sup>
BC4: 1	2068.59 m <sup>2</sup>
BC5	706.55 m <sup>2</sup>
BC5: 1	701.09 m <sup>2</sup>
BC5: 2	1407.64 m <sup>2</sup>
BC6	4030.85 m <sup>2</sup>
BC6: 1	30.44 m <sup>2</sup>
BC6: 2	4061.29 m <sup>2</sup>
BC7	1513.58 m <sup>2</sup>
BC7: 1	1513.58 m <sup>2</sup>
BC8	906.58 m <sup>2</sup>
BC8: 1	439.02 m <sup>2</sup>
BC8: 2	1345.60 m <sup>2</sup>
BC9	130.51 m <sup>2</sup>
BC9: 1	130.51 m <sup>2</sup>
<b>totaal: 13</b>	<b>15139.24 m<sup>2</sup></b>